

IMPORTANT

READ THESE INSTALLATION INSTRUCTIONS CAREFULLY before attempting to install the IC-A200 in an aircraft. This sheet contains important safety instructions for the IC-A200.

NEVER install the transceiver where normal navigation of the aircraft may be hindered.

NEVER install an antenna near any aircraft projection, engine, or propeller.

INSTALL a circuit breaker between the aircraft battery and the IC-A200.

NEVER install the transceiver in an aircraft with a 24 V battery. The transceiver operates with 13.8 V DC.

Check operation after installation.

Protect channel content **CANNOT** be changed by a customer.

INSTALLATION PROCEDURE

Install the IC-A200 according to the following procedure.

- ① Check the quantity of parts. Refer to UNPACKING.
- ② Prepare miscellaneous items required for installation. Refer to MISCELLANEOUS ITEMS.
- ③ Prepare required wiring. Refer to MOLEX CONNECTOR ASSEMBLY, COAXIAL CABLE ASSEMBLY and WIRING.
- ④ Assemble supplied mounting bracket and other parts. Refer to RACK MOUNT ASSEMBLY.
- ⑤ Cut the mounting hole. Refer to MOUNTING HOLE.
- ⑥ Mount the IC-A200 into the mounting bracket. Refer to RACK MOUNTING.
- ⑦ Check the IC-A200 operation. Refer to OPERATION CHECK.
- ⑧ Set protect channels, if required. Refer to MEMORY PROTECTION.

UNPACKING

The following parts are supplied with the IC-A200. Inspect the quantity of each part carefully.

Make sure you have received all parts and that there is no shipping damage.

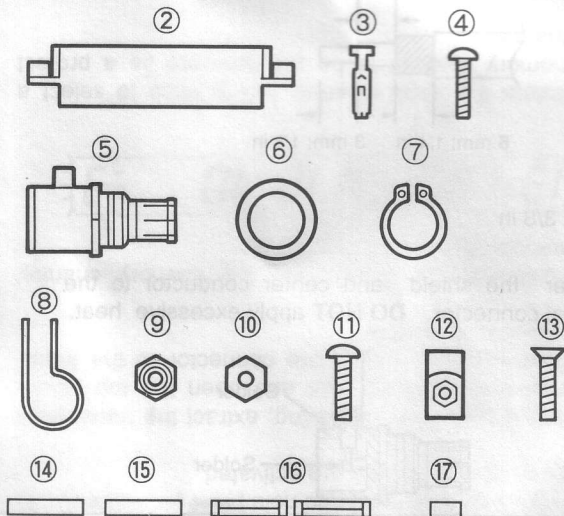
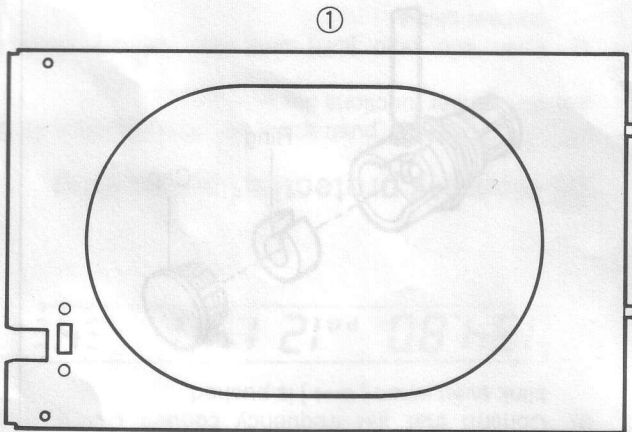

①	Mounting bracket.....	1
②	Molex connector (4338-15).....	1
③	Molex terminals (4366-GL).....	30
④	Screws (No. 4 × 1/2).....	2
⑤	BNC L-shaped antenna connector.....	1 set
⑥	Washer (Icom washer V).....	1
⑦	C-shaped ring.....	1
⑧	Antenna cable clip.....	1
⑨	Self-crimping nut (No. 6).....	1

⑩	Nut (No. 6).....	1
⑪	Screw (No. 6 × 1/2).....	1
⑫	Crimp nuts (No. 6).....	6
⑬	Screw (No. 6 × 1/2).....	6
⑭	COMM1 sticker.....	1
⑮	COMM2 sticker.....	1
⑯	Fuses (5 A).....	2
⑰	Molex polarizing key.....	1